

Beyond Divisions

Julia Lewandowska 5803683
Architectural Engineering Graduation Studio

Culturally diverse communities often struggle with prejudice and division among the member groups. Considering the current positive trend in globalization, and thus, also migration, the cultural diversity of communities is on the rise. As a result, The World Economic Forum assessed the erosion of social cohesion to be the 4th most dangerous risk on a global scale within the next decade (WEF, 2022).

Beyond Divisions is a proposal aimed at addressing this problem. Located in Lublin (Poland), which nowadays struggles with hostility and xenophobia, the building draws from the past cultural diversity of the site, to bring back the social cohesion lost during the WWII era.

Spanning between three historic temples (a Catholic church, an Orthodox church, and remnants of a Synagogue) the building incorporates symbolic elements of sacred spaces, creating a place for renewing the conversation about the different cultures and religions, as well as their relationship. The thread of that conversation became the inspiration for 'weaving' the structure creating a space 'out of the conversation' and for the conversation, while incorporating water into the design becomes a symbol of purification, renewal, and new beginnings.

The textile exhibition of archival statements from WWII survivors describing the cohesive, pre-war community of Lublin acts as a starter for discussing the topics of cohesion and division, prejudice, and respect. The gathering spaces created within the exhibition allow for this conversation to be carried out in a comfortable, intimate environment.

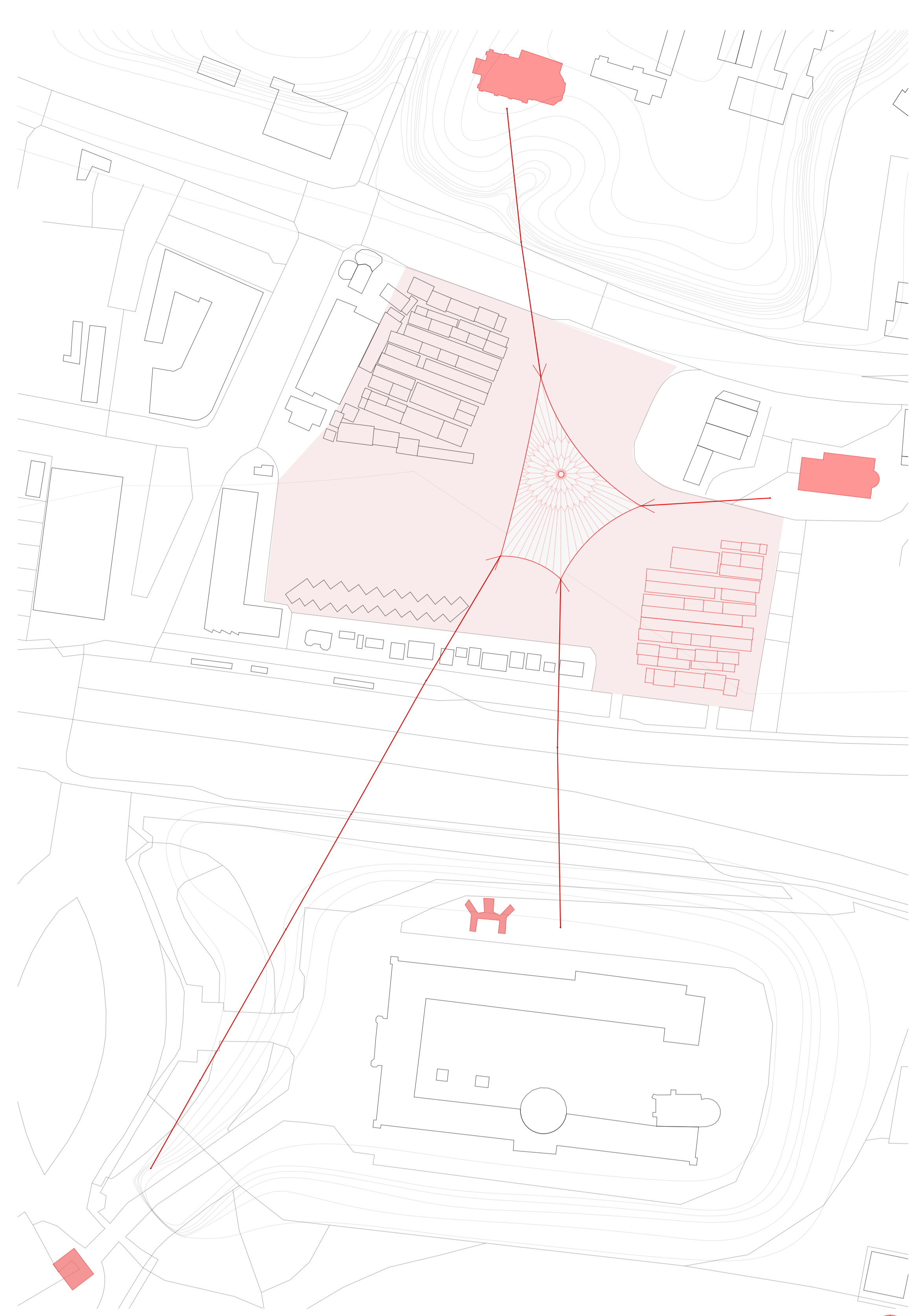

Site plan 1:1000

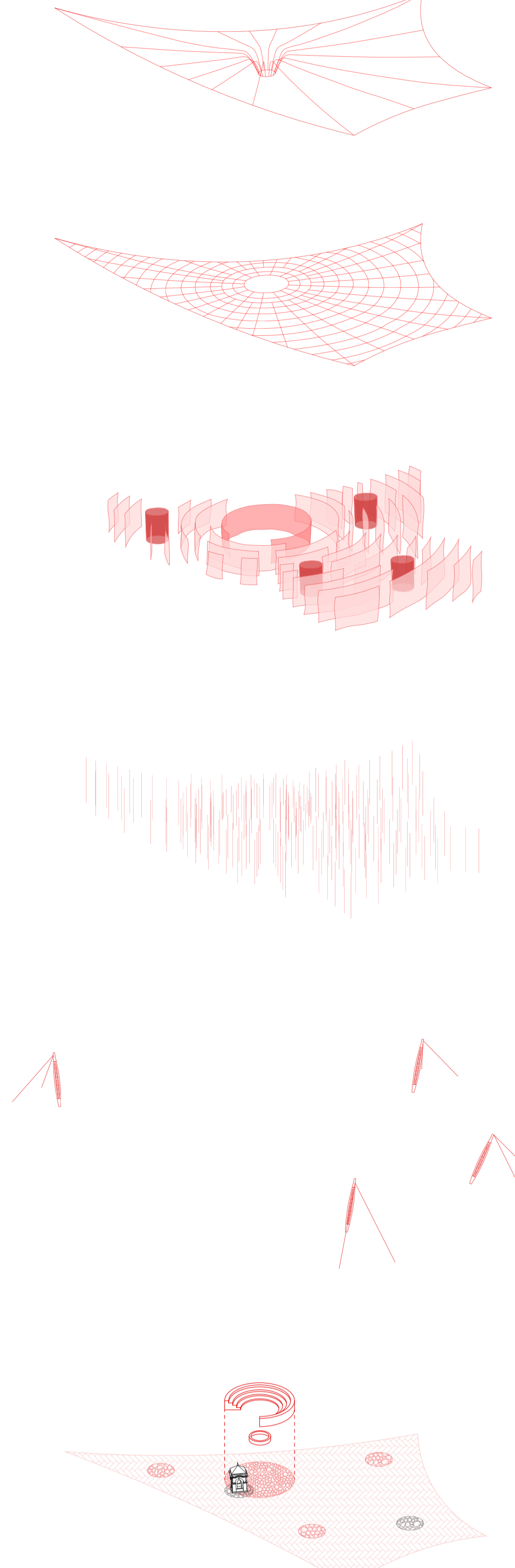

Exploded view

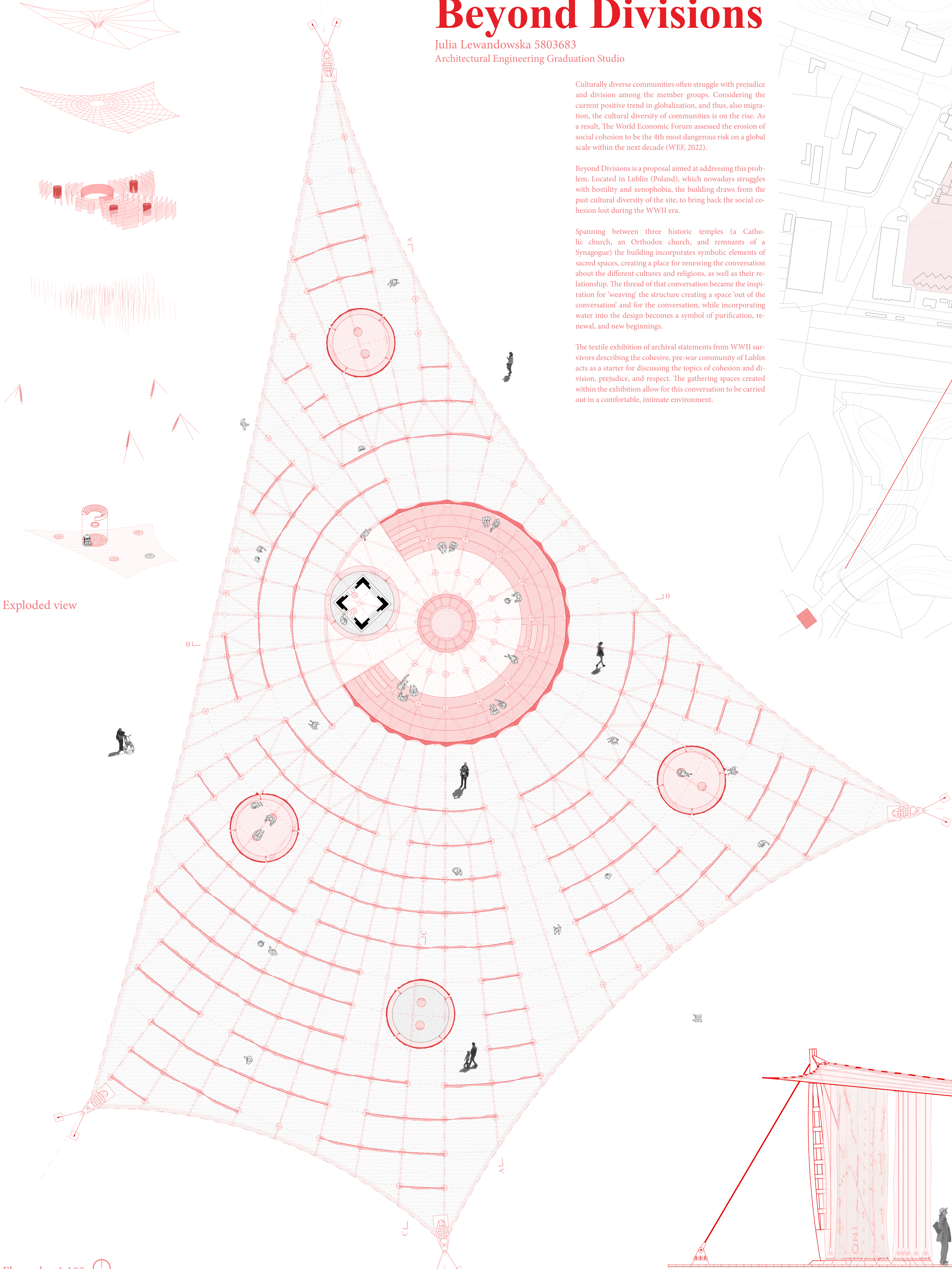

Floor plan 1:100

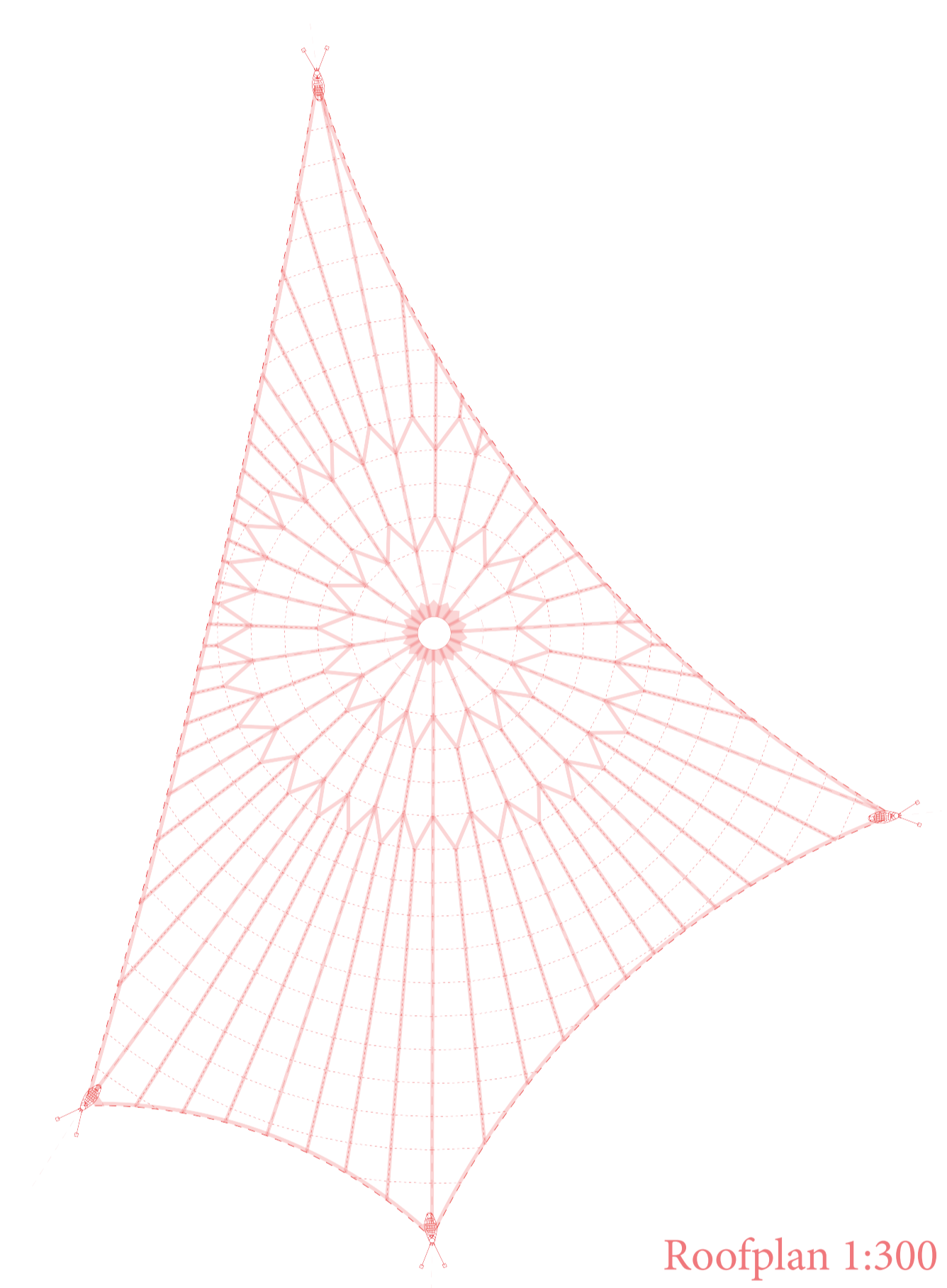

Roofplan 1:300



Section C 1:50

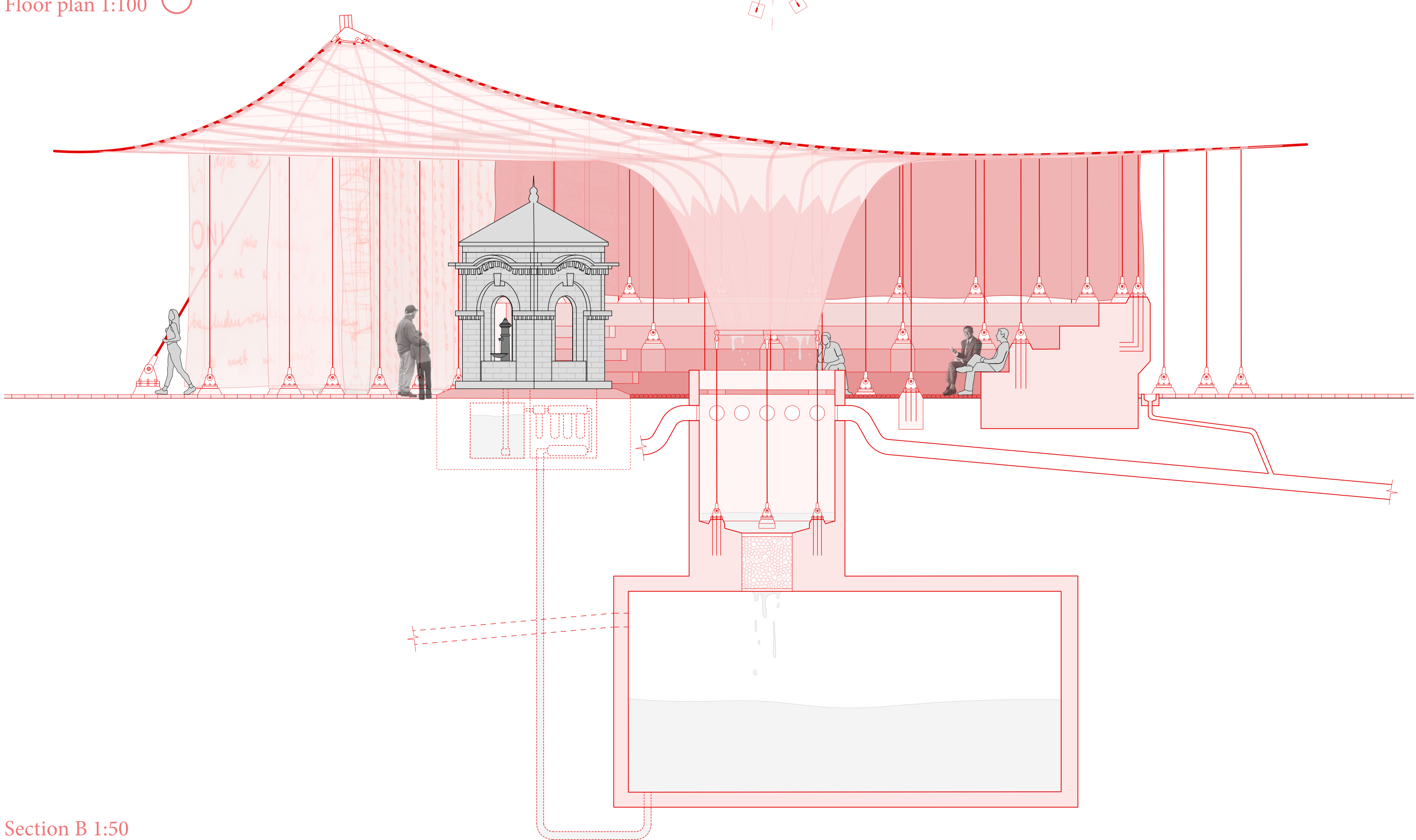

Section B 1:50

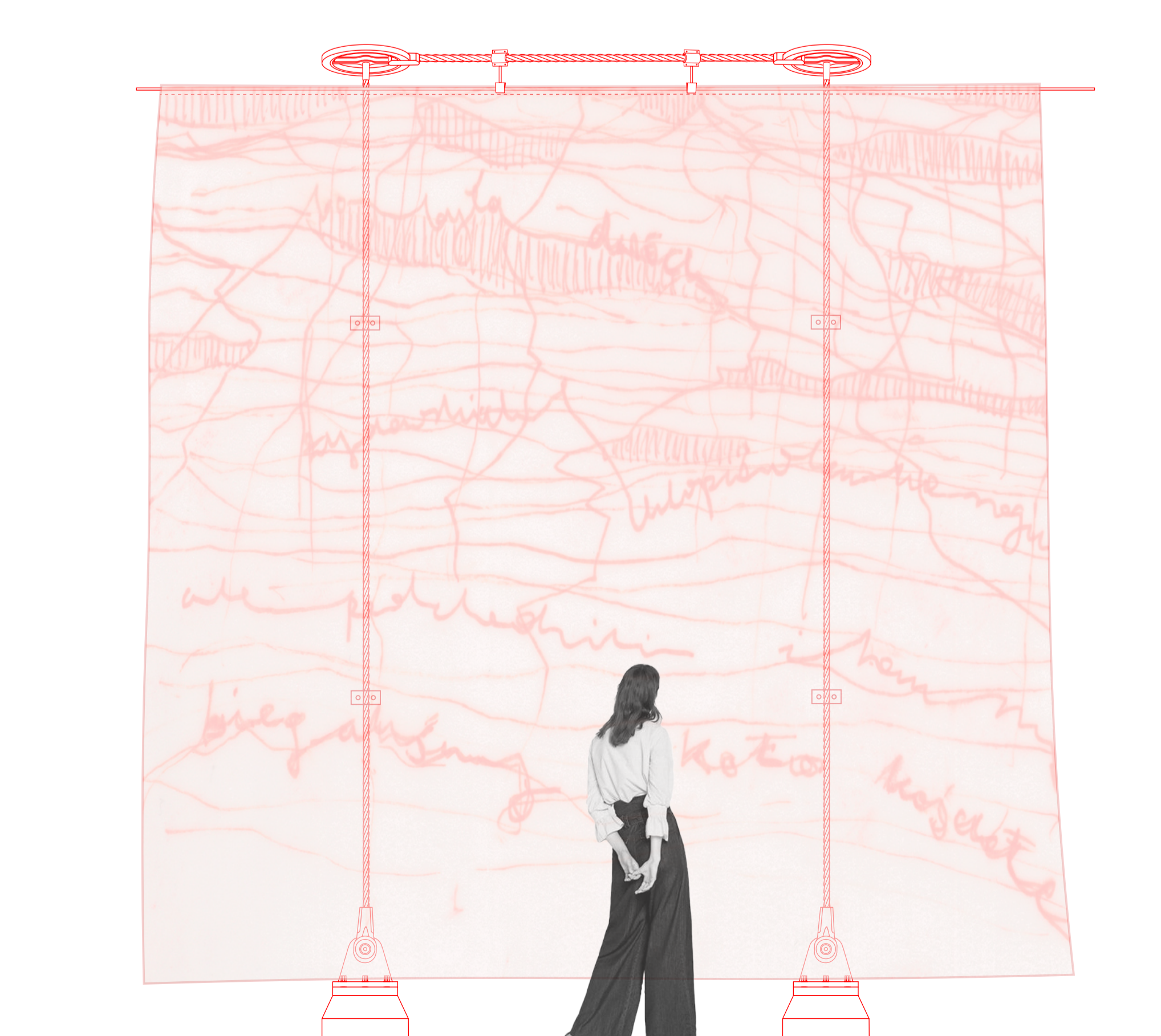

Exhibition Detail 1:20

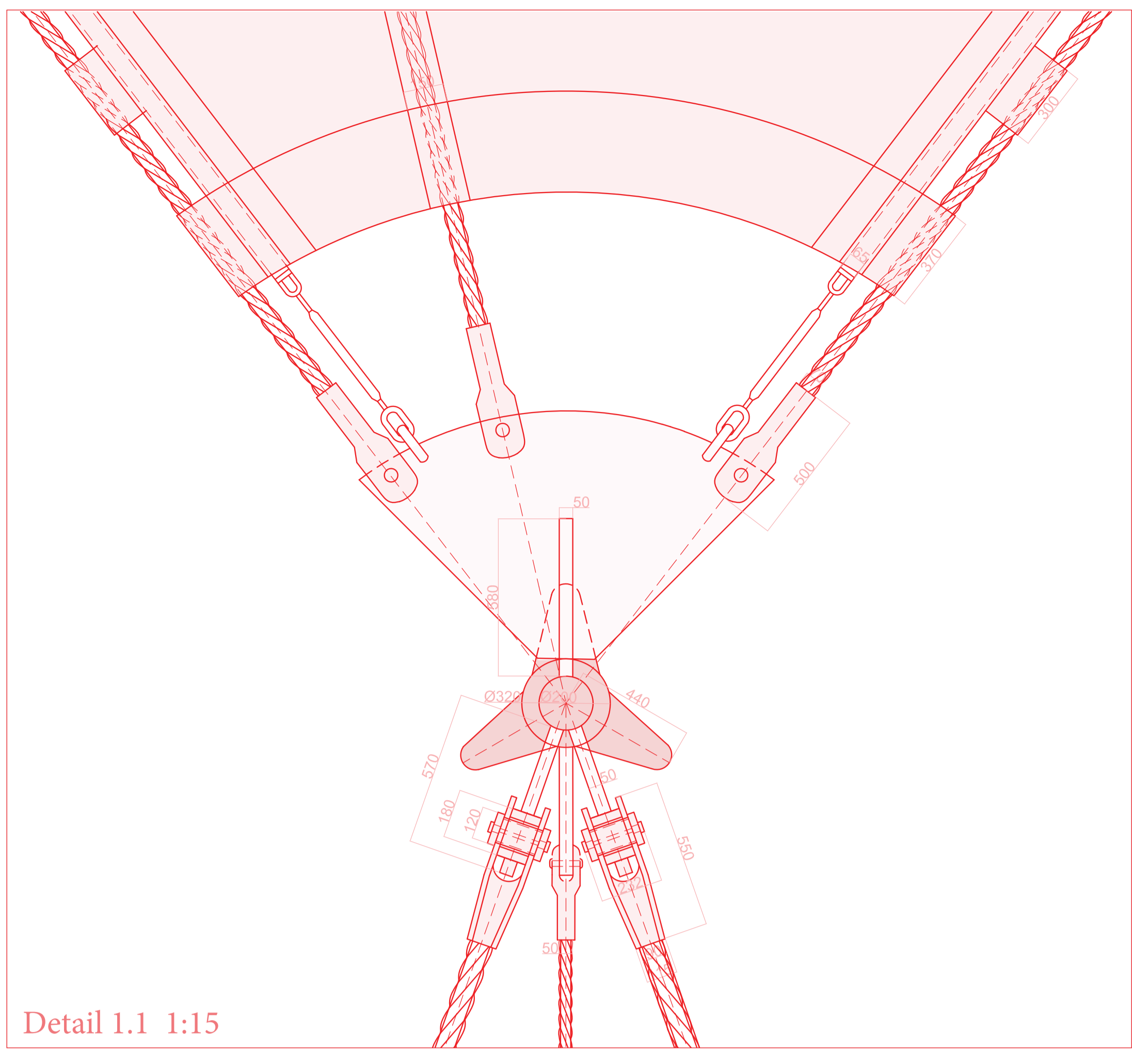

Detail 1.1 1:15

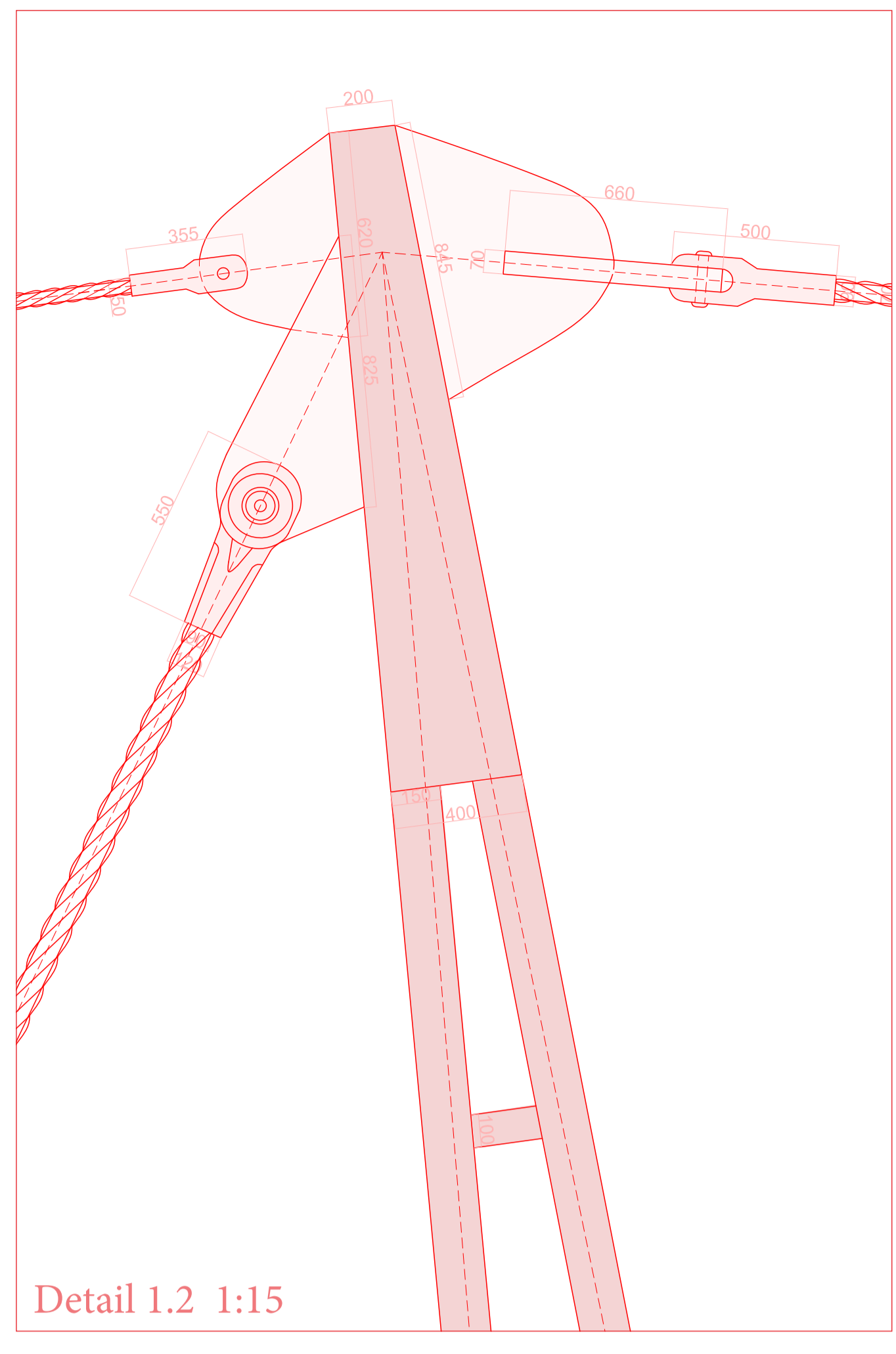

Detail 1.2 1:15

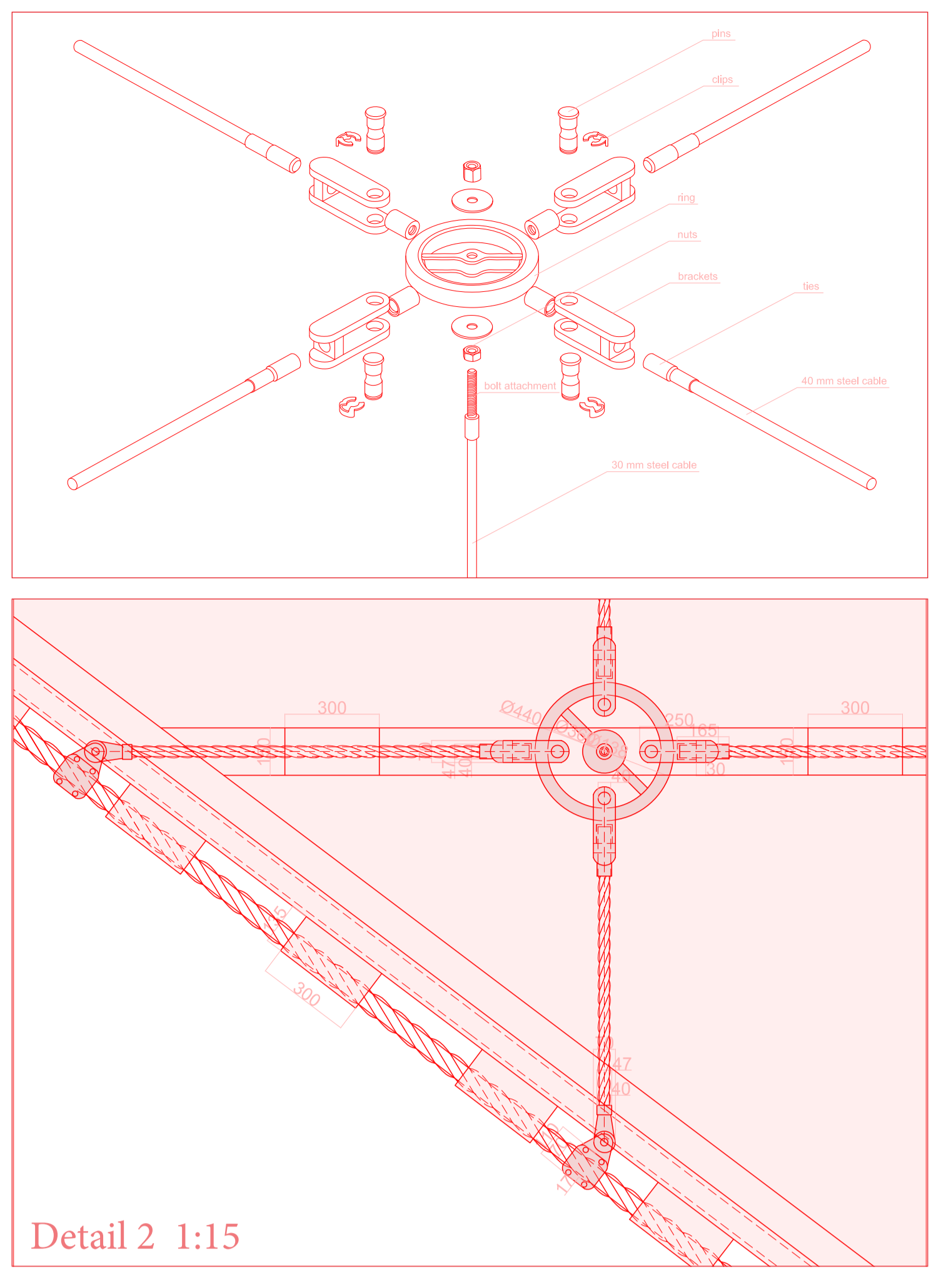

Detail 2 1:15

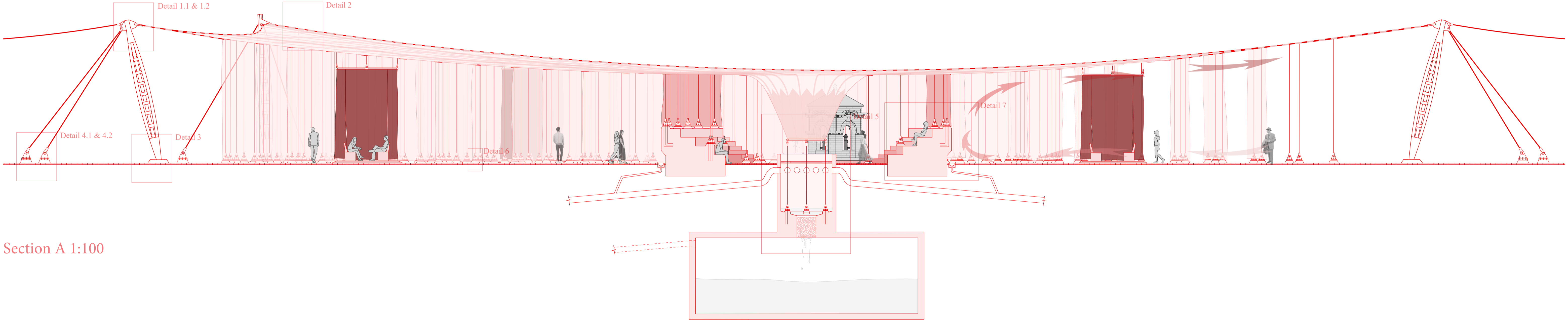

Section A 1:100

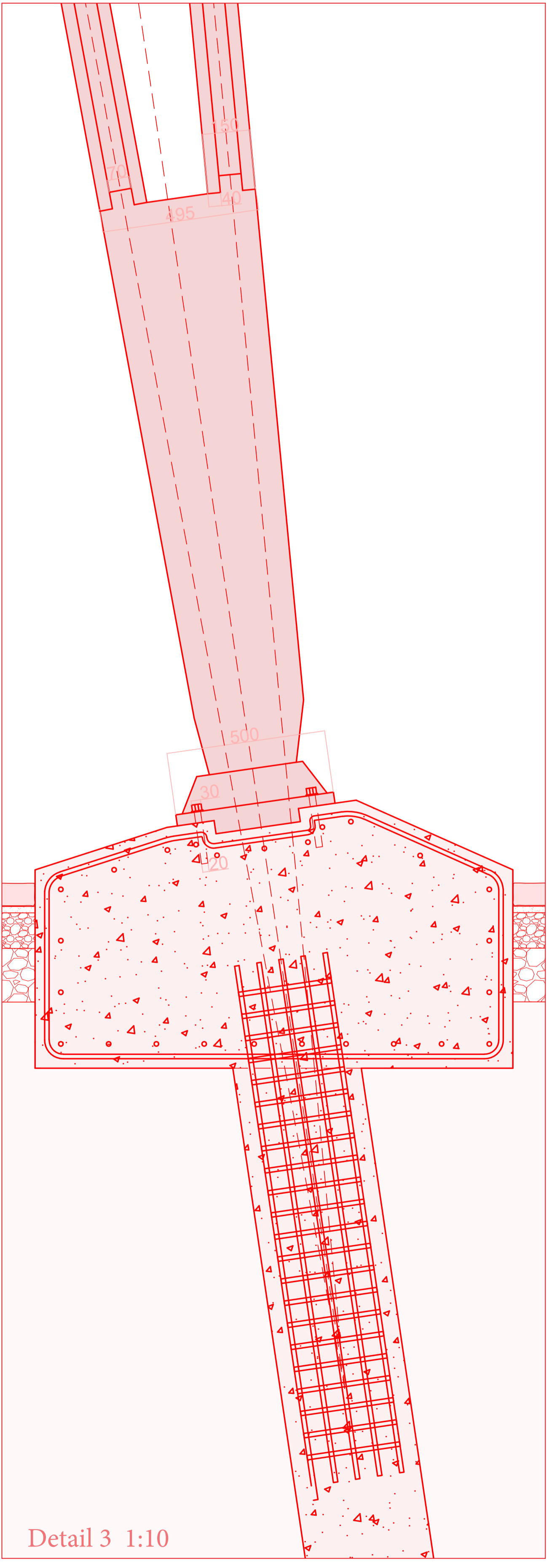

Detail 3 1:10

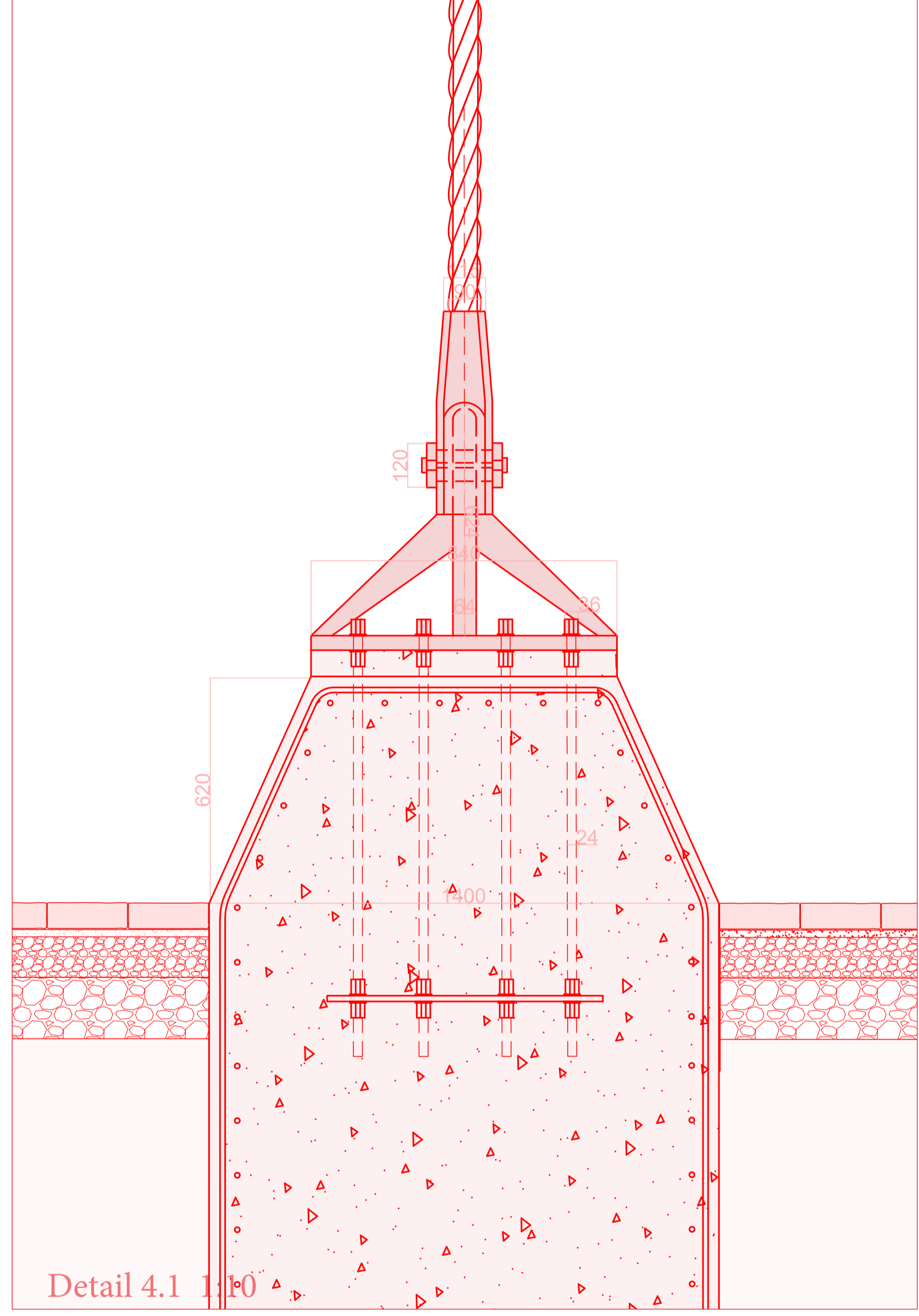

Detail 4.1 1:10

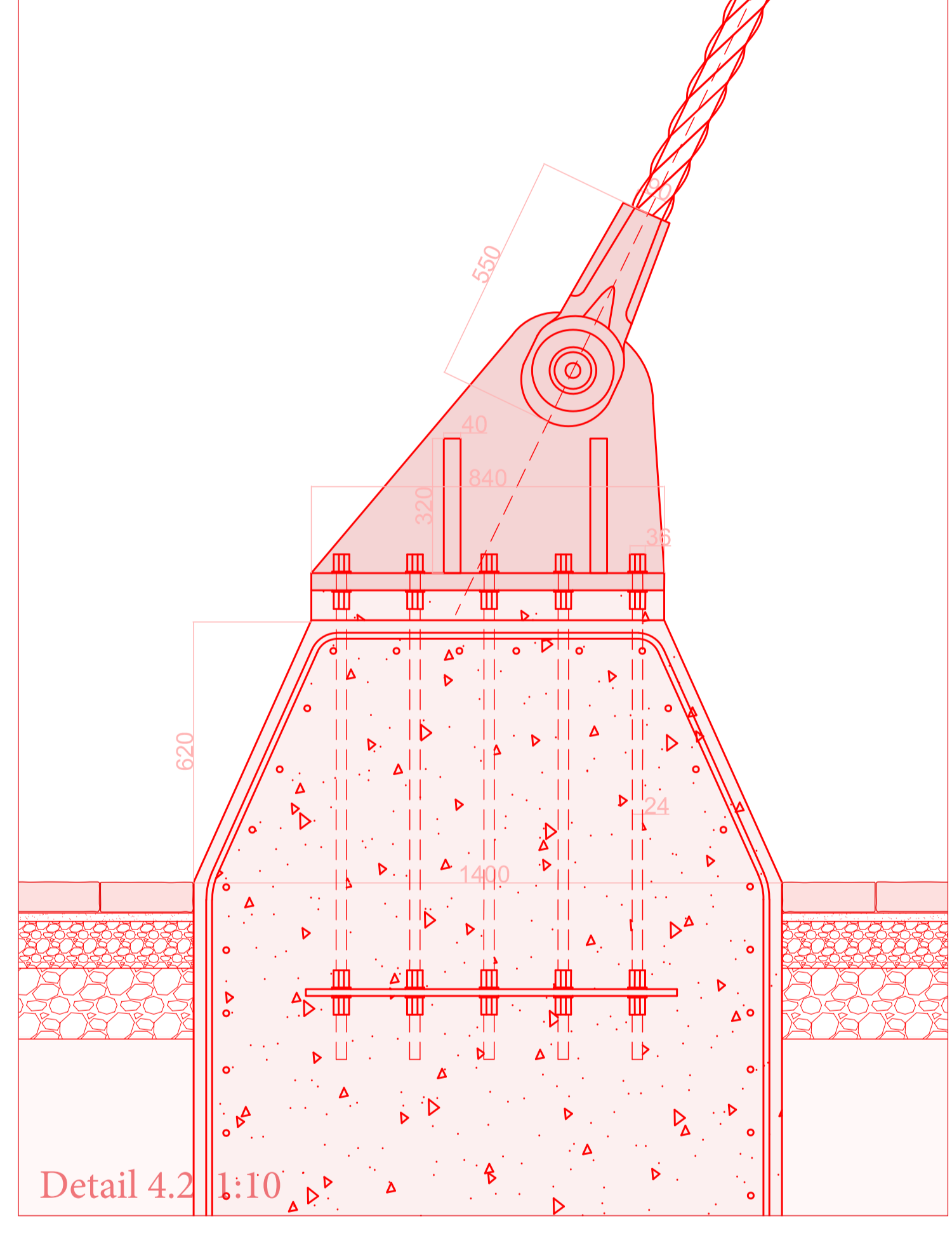

Detail 4.2 1:10

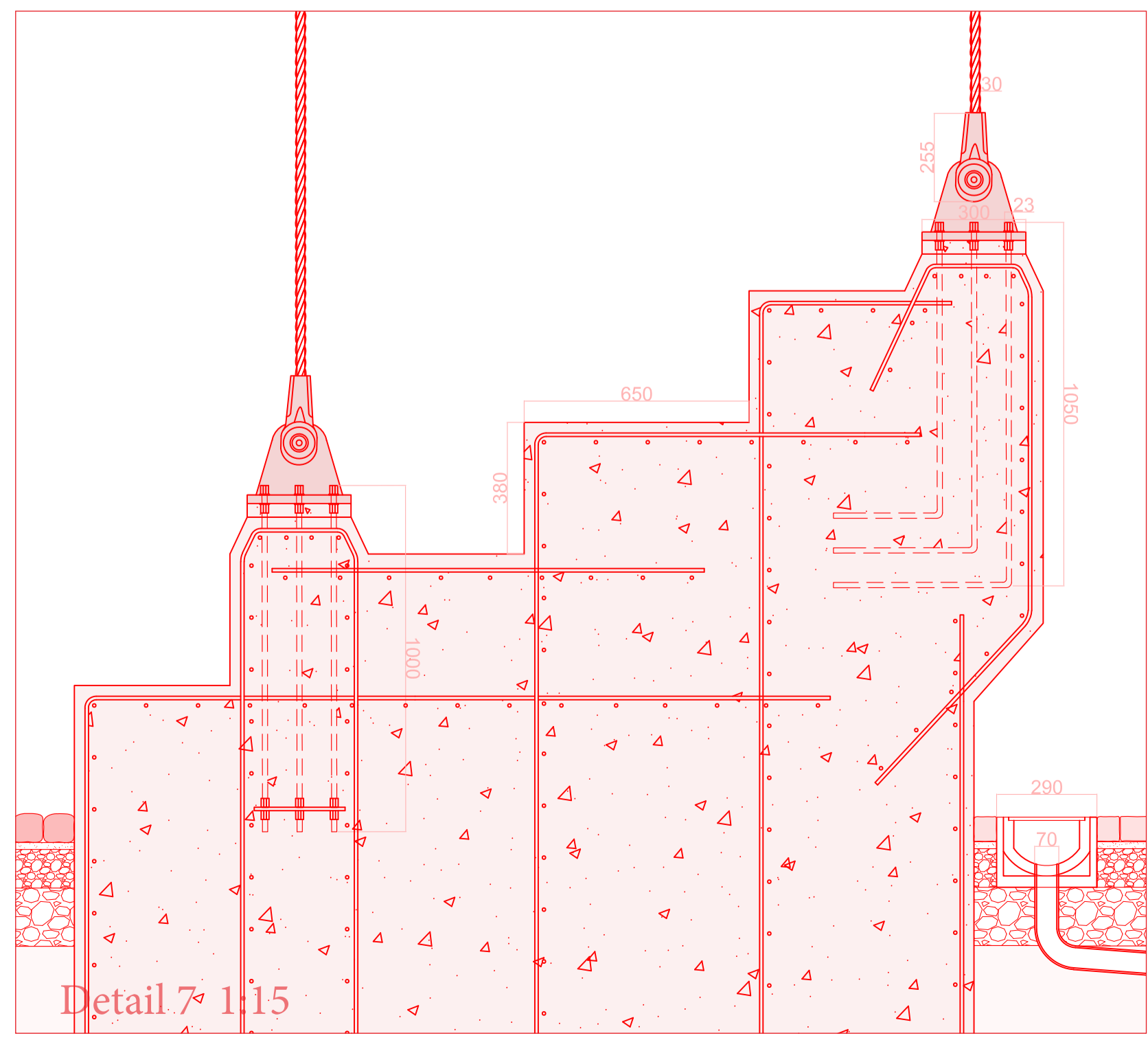

Detail 7 1:15

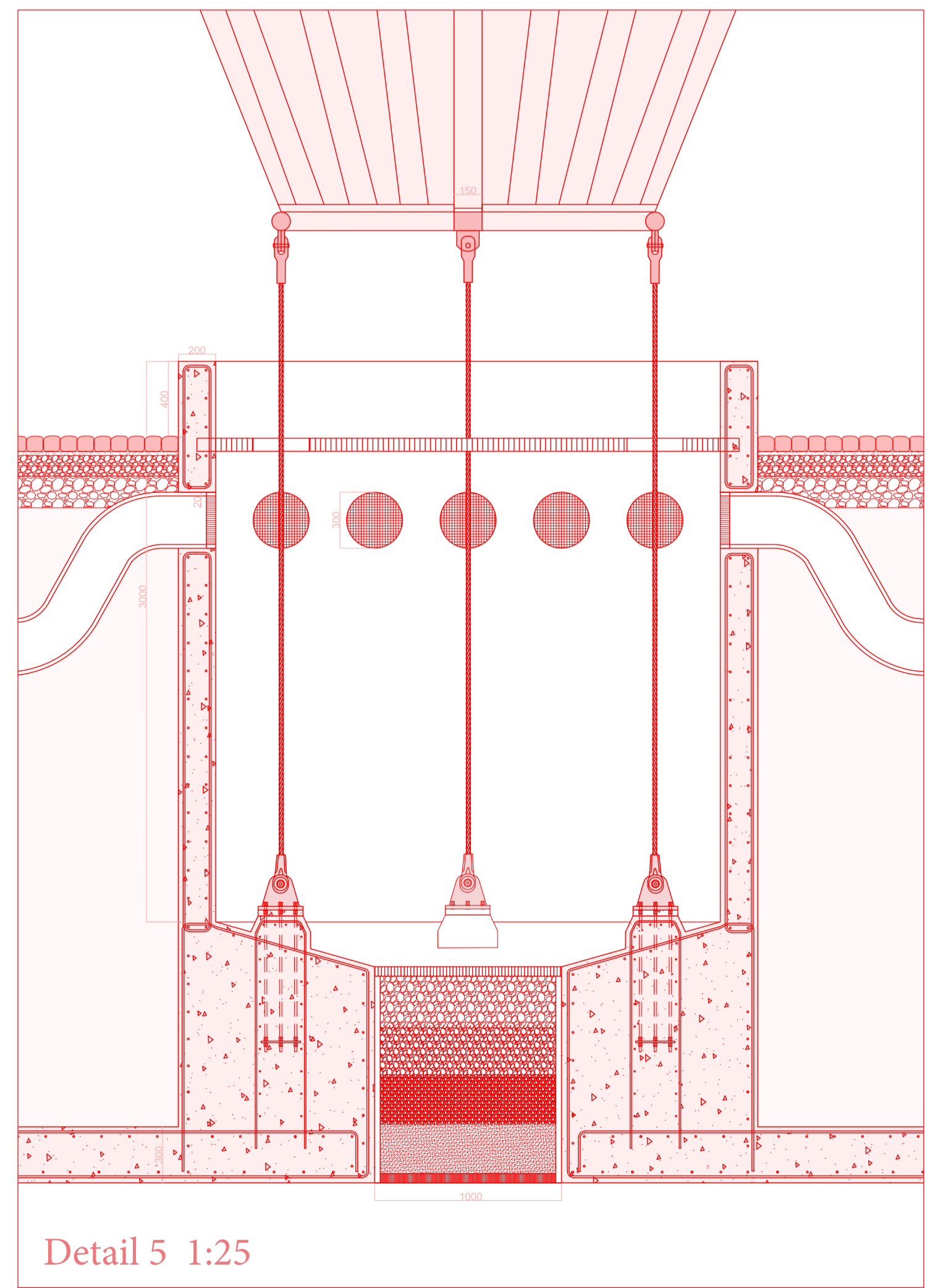

Detail 5 1:25

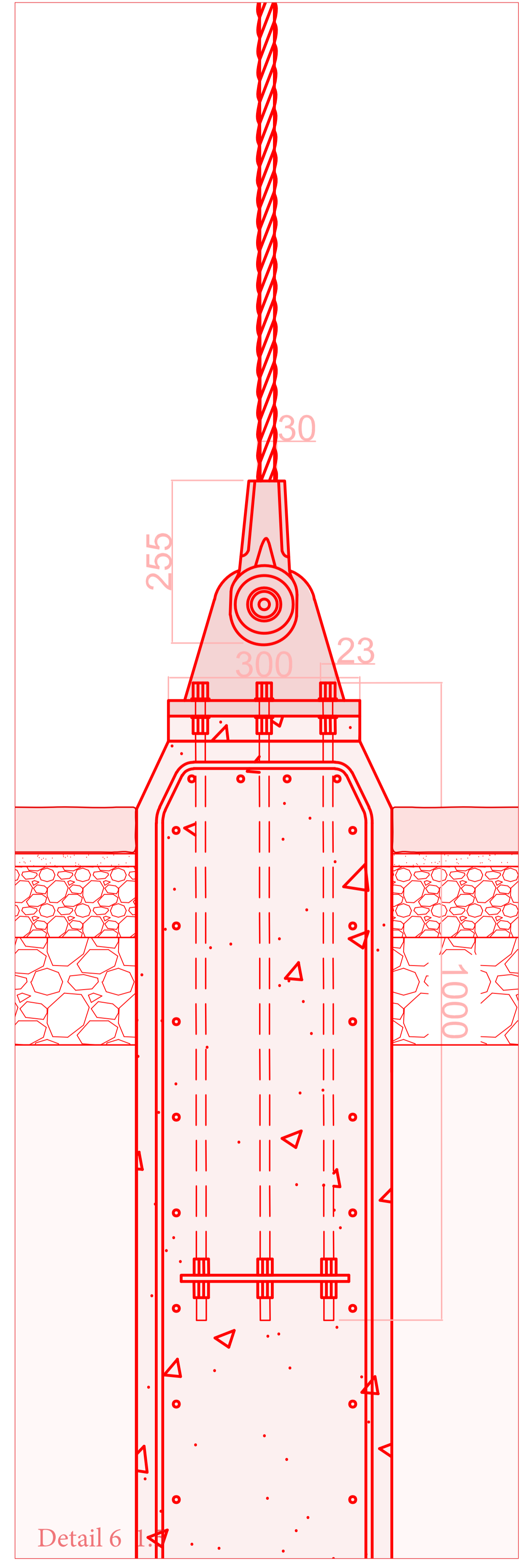

Detail 6 1:10